

MINUTES FOR JUNE 9, 2014
BOARD OF CHEROKEE COUNTY COMMISSIONERS
CHEROKEE COUNTY, KANSAS

CONVENE

Commissioner Hilderbrand called the regular session of the Cherokee County Board of Commissioners (The Board), to order and led all in attendance in the Pledge of Allegiance at 9:00 AM on Monday, June 9, 2014 in the Commission Room, #109 of the Cherokee County Courthouse located at 110 W Maple St., Columbus, Kansas. Commissioners Richard Hilderbrand, Charles Napier, Pat Collins, and County Clerk Rodney Edmondson were present.

Members of the press present: Larry Hiatt, Machel Smith, and Patrick Richardson

Sheriff David Groves - County Health Insurance Committee

He appeared before the Board representing the Health Insurance Committee. It's the recommendation of Brian Hilliar and the committee to add Mercy Clinic and four other physicians to the list of providers to be covered at network pricing.

A motion was made by Commissioner Collins to approve the recommendations of the Insurance Committee and add the providers as outlined in the agreement. The motion was seconded by Commissioner Napier. The motion carried 3-0 with all voting yes.

A motion was made by Commissioner Collins to approve the Minutes of the June 2, 2014 BOCC Meeting as written. The motion was seconded by Commissioner Napier. The motion carried 3-0 with all voting yes.

A motion was made by Commissioner Hilderbrand to amend the agenda from 9:30 a.m. to 9:15 a.m. for the Cherokee County Extension Council. The motion was seconded by Commissioner Napier. The motion carried 3-0 with all voting yes.

Clark Hall - Cherokee County Extension Council

He appeared with members of the Extension Council to present their 2015 Budget Request to the Board.

The request reflects an increase of approximately 1.78%, or nearly \$4,300. Auditing costs, equipment, and educational programs are some of the lines that were increased.

A motion was made by Commissioner Collins to approve the presented budget for fiscal year 2015 for the Cherokee County Extension Council. The motion was seconded by Commissioner Napier. The motion carried 3-0 with all voting yes.

A motion was made by Commissioner Collins to approve the Mid-Month Accounts Payables for June, 2014. The motion was seconded by Commissioner Napier. The motion carried 3-0 with all voting yes.

At 9:30 AM the Board recessed until 10:00 AM.

At 10:00 AM the Board convened in the District Courtroom for the meeting with KDWPT, KDHE and the Mine Reclamation project in Cherokee County.

Special Meeting with KDHE Mine Reclamation, and KDWPT

The Board, KDHE, and KDWPT conducted a public meeting in the District Courtroom to hear concerns from citizens over mined land reclamation taking place in Cherokee County.

RH

Murray Balk presented a program on Surface Mining Control and Reclamation in Cherokee County. Kansas began abandoned mine work in 1983. They have been doing work in Cherokee County for 30 years and spent \$13 million. The program is set to sunset in 2026, then Cherokee County would be responsible for any and all work needed in the area.

The Deer Creek II Reclamation Project has seen \$120,000 in road improvements. The total cost is \$3.5 million. It's been #1 on the inventory since the program began. Work is expected to finish this fall.

David Jenkins, manager of the Mined Land Wildlife Area, presented a program on the improvements made for fish and wildlife. The MLWA receives 300,000 visitors each year.

Both representatives stated that all other projects are small compared to the Deer Creek Project.

The meeting concluded at 11:35 AM.

At 11:45 AM the meeting reconvened in the Commission Room.

Jean Pritchett - Tourism Grant

She appeared before the Board with a Tourism Grant Request from "We Run Kansas" for a half marathon. The date is set for October 12, 2014. They are requesting \$300 in grant funds.

A motion was made by Commissioner Collins to approve the grant request from "We Run Kansas Half Marathon" for \$300 in tourism funds. The motion was seconded by Commissioner Napier. The motion carried 3-0 with all voting yes.

Kevin Cure - County Counselor

He appeared before the Board regarding legal matters concerning Cherokee County.

He reviewed the Agreement for Purchase of Services with Labette Community College and Commissioner Hilderbrand signed the agreement.

He estimates the next tax foreclosure sale to be held in early September.

Commissioner Hilderbrand made a motion to adjourn until the next regularly scheduled meeting set for June 16, 2014 at 9:00 AM. The motion was seconded by Commissioner Napier. The motion carried 3-0 with all in attendance voting yes at 12:15 PM.

ATTEST: Resolved and ordered this day, June 16, 2014

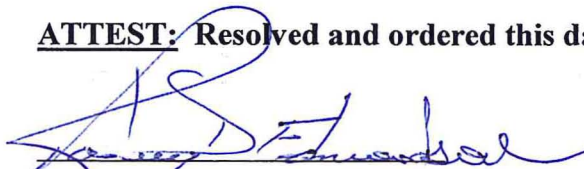
Cherokee County Clerk

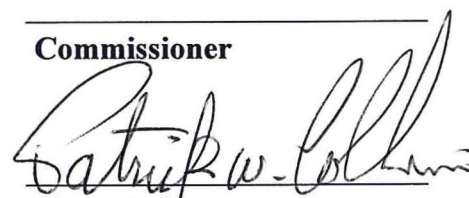
Commissioner

Commissioner

Commissioner

Commissioner

BUDGET FOR THE **CHEROKEE** **COUNTY EXTENSION COUNCIL**

For the Period from January 1, 2015 to December 31, 2015. This Budget is prepared in accordance with K.S.A. 2-610 as amended.

EXPENDITURES

| | | |
|---|----|------------|
| Printing, Audit, Treasurer Bond, Liability Insurance..... | \$ | 6,000.00 |
| Telephone..... | \$ | 2,950.00 |
| Rent, Heat, and Lights..... | \$ | 13,000.00 |
| Supplies, Stationery, and Postage..... | \$ | 4,000.00 |
| Equipment..... | \$ | 18,500.00 |
| Educational Program Support..... | \$ | 6,000.00 |
| Travel..... | \$ | 9,500.00 |
| Subsistence..... | \$ | 2,500.00 |
| Salaries and Wages..... | \$ | 153,091.00 |
| Employee Benefits..... | \$ | 40,000.00 |
| | \$ | |
| | \$ | |
| Sub-Total..... | \$ | 255,541.00 |
| Nonappropriated Funds (Reimbursable Transactions)..... | \$ | 20,000.00 |
| Equipment Replacement Reserve..... | \$ | 20,000.00 |
| TOTAL EXPENDITURES..... | \$ | 295,541.00 |

RECEIPTS

| | | |
|--|----|------------|
| Unencumbered Cash Balance..... | \$ | 0.00 |
| Kansas State University..... | \$ | 50,648.00 |
| County Appropriation..... | \$ | 204,893.00 |
| Interest and Other..... | \$ | 0.00 |
| | \$ | |
| Sub-Total..... | \$ | 255,541.00 |
| Nonappropriated Funds (Reimbursable Transactions)..... | \$ | 20,000.00 |
| Equipment Replacement Reserve..... | \$ | 20,000.00 |
| TOTAL RECEIPTS..... | \$ | 295,541.00 |

Proposed Clark D. Hall
Representing County Extension Council

Date 6/9/14

Proposed and Approved* [Signature]
Representing the Director of Extension

Date 5-5-2014

Approved [Signature]
Representing Board of County Commissioners

Date 6-9-14

*The signature of the Director of Extension or the Director's representative constitutes approval of expenditures in accordance with K.S.A. 2-615 and K.S.A. 2-610 as amended.

Columbus Chamber of Commerce

320 E. Maple * Columbus, KS 66725 * 620-429-1492

APPLICATION

CHEROKEE COUNTY TOURISM GRANT PROGRAM 2014

PLEASE USE ONLY THIS FORM

IF MORE SPACE IS NEEDED, PLEASE ATTACH ADDITIONAL SHEETS
ALL GRANT APPLICATIONS SHOULD BE TYPED.

DATE OF REQUEST MUST BE MADE AT LEAST 60 DAYS PRIOR TO EVENT

Date of Request 04/25/2014

Name of Event/Project We Run Kansas Half Marathon

Date(s) of Event/Project October ~~11th~~, 2014 ^{12th}

Name of Sponsoring Organization We Run Kansas

Briefly describe event/project 13.1 mile race

Person making Grant/Request Stephen Mattice

Address 423 N. Kansas Ave. Columbus, KS 66725

Work Phone 620-429-1332 Home Phone 913-704-8929

Grant amount being requested (\$300 maximum) \$300

Is this event in any way a fundraiser for your organization? yes no

Estimated number of expected attendees 150 - 1,000 + families

Estimated number of room nights generated: 20

Estimated number of attendees that are day-trippers 150 - ?

Where will they stay while in Cherokee County? hotels

How will grant money be used (be specific) Pay for chip timing, race awards, race packets

Attach projected budget for entire event/project to this application.

Where will visitors come from? four state area and beyond

Is this a one-time event? An on-going project? Explain This is a first year half marathon which we would like to continue annually.

Have you received prior funding from this grant? Explain NO

How will this event/project increase tourism revenue in Cherokee County? Runners are willing to travel great distances to participate in half marathons. They will bring families, stay in hotels, eat at restaurants, and shop.

If event/project will not directly affect tourism, how will it improve or enhance Cherokee County to indirectly affect tourism? (See attached narrative.)

Additional support from this grant application may be attached if desired.

This grant is not meant to be a supplement to your budget every year – it is intended to get your event started.

IMPORTANT: Upon completion of event/project, all grant recipients must supply the Columbus Chamber of Commerce Tourism Committee with actual budget for event/project and follow-up summary. Recipients who do not comply with this policy may be ineligible for future grants.

Committee Use Only: Date received _____ Action _____



WE RUN KANSAS, Inc.

Long Distance Running Team

EIN # 46-2506810 Kansas Not for Profit Corp. ID # 6871123

This year, the We Run Kansas long distance running team is planning a half marathon race which will take the contestants on a 13.1 mile trip through both the city limits and rural areas of Columbus. The race will begin at the clock tower in front of the Cherokee County Courthouse, and end at the city park on S Kansas Avenue. Participants in this half marathon will literally take a tour of Columbus, running by nearly every Columbus business, a section of Highway 160, the rural countryside of both East and West Maple as well as East and West Country Road, the Cherokee County Law Enforcement Center, Titan Alley, and the city square.

The plan is for this race to be held in October during Columbus Days, attracting more visitors to the area for the Columbus Days events. The timing of this race is of most importance in 2014, as the Mother Road Marathon announced on December 2nd, 2013 that their race has been cancelled indefinitely. The cancellation of the Mother Road Marathon has opened the door for greater participation potential in the We Run Kansas Half Marathon in Columbus, as runners will be searching for events in lieu of the Mother Road.

As this is a first year event, it is difficult to predict the actual number of runners who will compete in this race, but with proper planning, the event could literally see a thousand or more participants. I have begun the process of contacting companies for the race timing, medals, age placement awards, and t-shirts. We would also like to include "swag bags" to give to each runner with their race packet. Included in this bag would be small items from sponsoring businesses. These items could be key chains, magnets, business cards, pens, etc. This event will be conducted with the utmost professionalism in order to attract runners from both near and far, and to create an event that can be scheduled annually.

We are currently seeking financial sponsorship to assist with the cost of planning a top notch excellent half marathon. Thank you for your consideration.

Stephen Mattice 913-704-8929

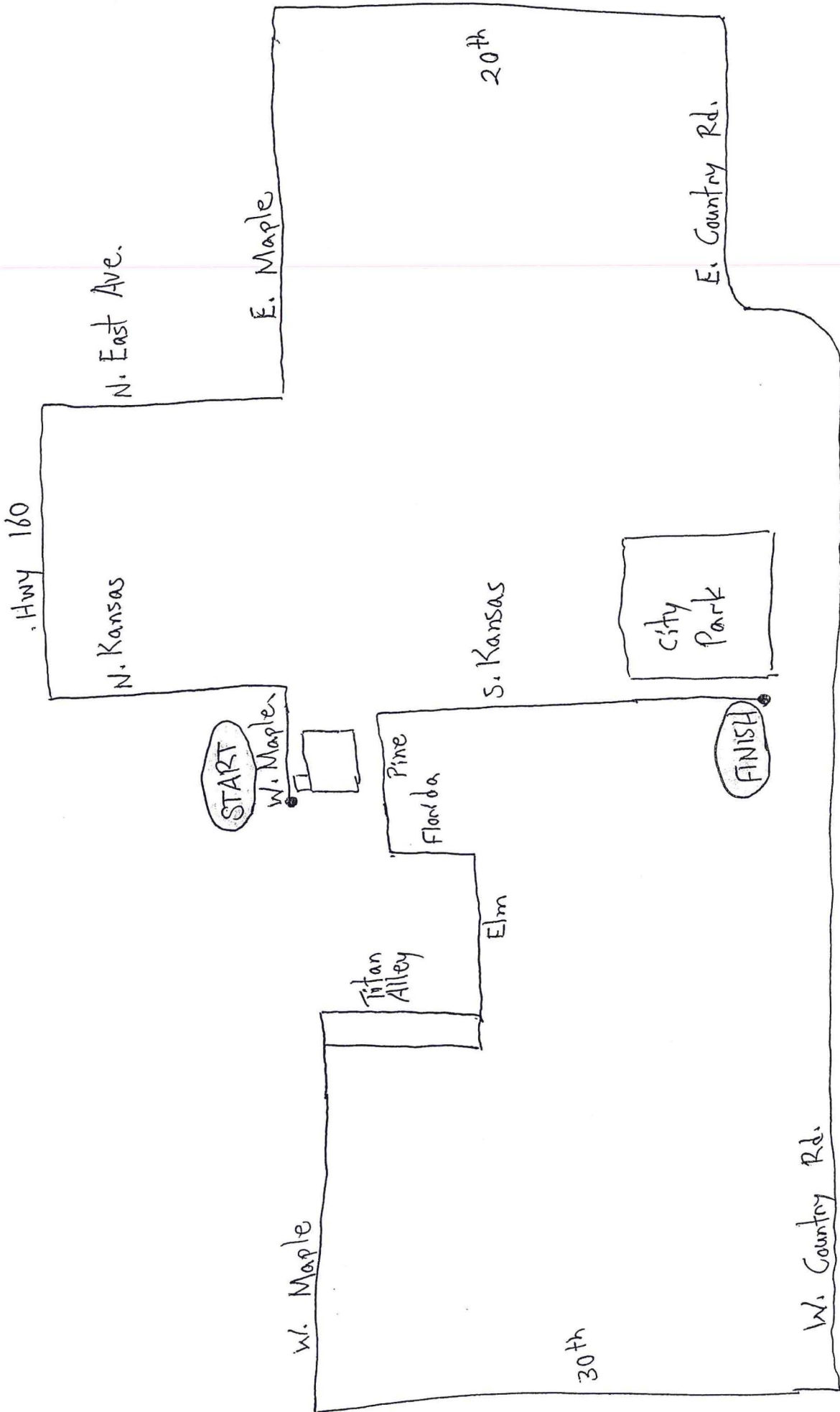

AGREEMENT FOR PURCHASE OF SERVICES

This AGREEMENT, made and entered into the 3rd day of June 2014, by and between LABETTE COMMUNITY COLLEGE, hereinafter called "College," and, Cherokee County, hereinafter called "Provider."

WHEREAS, the Kansas Community College Task Force has charged the Kansas Community College system with the following mission, among others:

- * To provide customized educational training programs to assist qualified employers to train their employees in job related skills;
- * To provide courses, associate degree programs, certificates, and other vocational/technical training to prepare students to update their job skills, to advance in their jobs, to retrain in new job fields or recreation/personal growth opportunities to allow employees to remain productive in a competitive environment.

WHEREAS, The Kansas Board of Regents has set policy on the provision of education and training to providers.

WHEREAS, the College desires to utilize the services of the Provider in providing both specialized and general education to students of the college.

WHEREAS, the Provider desires to provide the services to the College and to provide the College the benefit of its unique skills, knowledge, facilities, and equipment toward carrying out the educational mission of the College and thereby improving the educational opportunities of its employees.

NOW, THEREFORE, the College and the Provider agree as follows:

- I. Services to be provided. Services provided to the College by the Provider shall include but not be limited to the following:
 - a. Classroom facilities. Cherokee County will serve as a training site for educational programs or classes conducted by the College. The Provider will maintain complete authority and control over classroom facilities at Cherokee County facility. The furnishing of the aforesaid facilities shall be subject to the scheduling and control of the Provider in keeping with the rules and regulations of the College. Employees shall be subject to the scheduling and control of the Provider in keeping with the rules and regulations of the College.
 - b. Equipment usage. The Provider will make available to the College access to and use of equipment necessary to conduct specialized training in the operation, use or maintenance of such equipment.
 - c. Faculty. The Provider will offer, when appropriate, qualified faculty members who will be under a College instructional contract for the programs. The faculty will be responsible to the college for the instruction, control and supervision of the students consistent with the rules and regulations of the College.
 - d. Consulting. The Provider will provide consulting services to the college based upon unique skills of its officers, employees or agents. Such consultation may relate to course curriculum, personal educational needs of employees or other areas as deemed appropriate by the College.

- e. Supplies. The Provider will make available to the College supplies or course material deemed appropriate by the College and the Provider.
 - f. General. The Provider will offer such other services as may be agreed upon from time to time.
- II. Scholarships. The College agrees to provide scholarships, including normal fees, to employees of the Provider based on a request for the training and verification of employment by the employer; verification must be received during each semester in which the employee is attending the College. The employee will pay material, lab and other equipment usage fees incurred through enrollment in training.
- III. Students. It is understood that the Provider may from time to time enroll individuals designated by the Provider in classes offered by the College.
- IV. Offering of Courses. The determination of courses to be offered and the determination of the number of students required to offer a course shall remain at the sole discretion of the College in consultation with the Provider. The Provider reserves the right to restrict the types of courses covered by this agreement. If the Provider restricts the courses, an attachment will be added to this document.
- V. Termination or Modification of Agreement. This agreement is for a period of one (1) year and is renewable. The agreement may be terminated by either party at the conclusion of any semester by providing the other party with written notice sixty (60) days prior to the beginning of the next semester.

LABETTE COMMUNITY COLLEGE

BY _____

Dr. George C. Knox, President

CHEROKEE COUNTY

BY  _____

Cherokee County Board of County Commissioners

Attendance of Meeting held on: 6/9/14, 2014

| Name | Address |
|------------------|--------------------------------|
| Dulcy Johnson | |
| Florine Stutz | 5285 NE Hwy 103 Weir KS |
| Ed Vandenberg | 1501 NW 30 Columbus KS |
| John Riser | 10 West Mackie Scammon |
| Larry Waugh | 9060 NW Coalfield McCune |
| Lloyd Deckard | 218 E Sycamore Columbus, KS |
| Harley McDaniel | 1219 Sunset Cir. Columbus, KS. |
| Ron Thomas | 407 S. VERMONT Columbus. |
| Dorcy Stephens | 401 S High st. Weir KS |
| Bob St. Clair | 504 Garfield Baxter Spgs KS |
| HAROLD SKIDLER | 5189 NW COAL VALLEY RD |
| LeBonnie Mesplag | 101 Joplin St. West Mineral |
| Mike Fowzer | 6894 SW 10th St Columbus |
| Janet Miller | 803 W. Elm Columbus |
| Leonard Vanatta | |
| Chris Wiley | 200 Parmenter Ave Columbus KS |
| DALLAS TEDFORD | 3569 N.W. 10th St COLUMBUS, KS |
| Robert A West | 311 North Alordia Columbus, K. |
| Gregg Martin | 925 SW 30th Columbus KS |
| Gerald Messer | 620-674-1550 Columbus |

Cherokee County Board of County Commissioners

Attendance of Meeting held on: June 9, 2014

| Name | Address |
|------------------|---------------------------------|
| Larry McOverman | 6874 NW 70th McCune, KS |
| Frank N. Swank | 6966 NW Center Street Columbus |
| Matt Fidds | 720 Elm Galena, KS |
| Kay Hulsey | 10972 NW 3rd Dr. Cherokee, KS |
| Gerry Hulsey | 10972 NW 3rd Dr. Cherokee, KS |
| John [unclear] | 802 E Pine Cherokee Kansas |
| Darryl Brown | 1838 S-E Hwy 160 Columbus KS |
| Daryl Spear | 7415 W. 20th Columbus, KS. |
| Francis Garrison | 1779 S. E. W. Road |
| Pam Henderson | Po Box 1372 Pittsburg |
| Nate Stahl | 110 East Oak Arma KS |
| Paul Koons | 841 NE Bethlehem Columbus |
| Logan Martin | 507 E 560th Ave. Pittsburg |
| James Jones | 411 Larch Cherokee, KS |
| Sarah Gooding | The Morning Sun - Pittsburg |
| Mary Casey | 1410 E Buckeye Columbus |
| [unclear] | 1410 E Buckeye Columbus KS |
| [unclear] | 7970 NW Colfield Rd McCune KS |
| Darryl Lawson | 9793 SE Hesse Rd. Holvate |
| Dana A. Hobbs | 2360 SW 20th Columbus, KS 66725 |

Cherokee County Board of County Commissioners

Attendance of Meeting held on: June 9, 2014

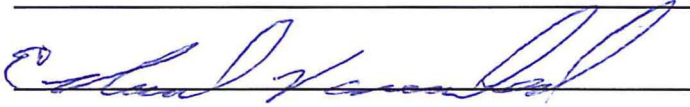
| Name | Address |
|--------------------|--|
| John Bullard | 1925 Brassart, Columbus |
| John Epler | 8770 SW Messer |
| Charlie M. Cohen | Col., ks. |
| Michael R. Mordica | P.O. Box 153 Cherokee KS 66724 |
| Robynn Snow | PO BOX 75 Scammon KS 66773 |
| Jean Pritchett | Col. Chamber of Commerce |
| Pat Ellison | Box 149 Columbus 66725 |
| Virgie Hilliard | 1837 NE Hwy 160 Columbus, ks |
| Frank W. Hilliard | " " " " " |
| Harold W. Piller | 4488 SE 7 th 15 Columbus KS |
| Kathy Dahuby | 216 N. Hill, Columbus, KS |
| Mari Fonda | Col. Linn et |
| Vern Wagner | 7521 NW 60 th McCune, KS |
| Don Rando | H+K Campers |
| Carl Johnson | H+K Campers |
| Kregg Pernice | 6607 NW Lawton Rd Columbus |
| Ross Lovel | 12 SE 100 th Galena ks. |
| R.R. Ball | Wimberly KS 66782 |
| R |  |
| Zuni Z. Yearwood | 1993 NE HWY 2 Columbus KS |

Cherokee County Board of County Commissioners

Attendance of Meeting held on: June 9th, 2014

| Name | Address |
|---------------------|--------------------------------------|
| Deborah DeVoe | 2259 SW Clem Columbus KS |
| John Rion | 512 S. Grand Weir Ks. 66781 |
| John D. Johnson | 8641 NW 10th St, Cherokee |
| Dean Messer | Scammon KS. |
| Darrell Thompson | Weir, Ks. |
| Jim Smith | 6259 SW ^{60th} Columbus, Ks |
| DARRYL W. WADSWORTH | 210 FLORIANE WEST MINERAL |
| JEFF WILSON | 4161 SE Hwy 69 Columbus. |
| James Lecian | 205 N BAY AVE Columbus |
| James McCracken | 500 S.W. Clem RD. |
| Tom Vanotto | 4760 SW 30th Columbus |
| Zachary Kresyman | 760 SW LOSTINE RD. |
| FRANK MARJORAWA | 9275 SW BLACK BIRD LN. |
| Sam Gray | 544 W Olive |
| Laurie Tye | 620 875-1738 |
| Carl A Cole | 5895 NW 19TH TERR SCAMMON KS |
| Ben Judy | 300 ELM ST WEST MINERAL |
| Tex Hulvey | 538 S. MINN. Columbus |
| HARRY FIELDS | 8758 SE Hwy 66 Galena, |
| Mendy Hulvey | 1282 S. 220th Pittsburg, Ks 66762 |

